

NOTE:
 THIS DRAWING AND DESIGN IS THE PROPERTY OF
 INTERCLEAN EQUIPMENT INC. AND MUST NOT BE
 COPIED OR USED EITHER DIRECTLY OR INDIRECTLY
 FOR ANY WORK OTHER THAN THAT OF INTERCLEAN
 EQUIPMENT INC. WITHOUT SAID COMPANY'S
 EXPRESSED PERMISSION. ALL RIGHTS OF INVENTION
 OR DESIGN ARE RESERVED.

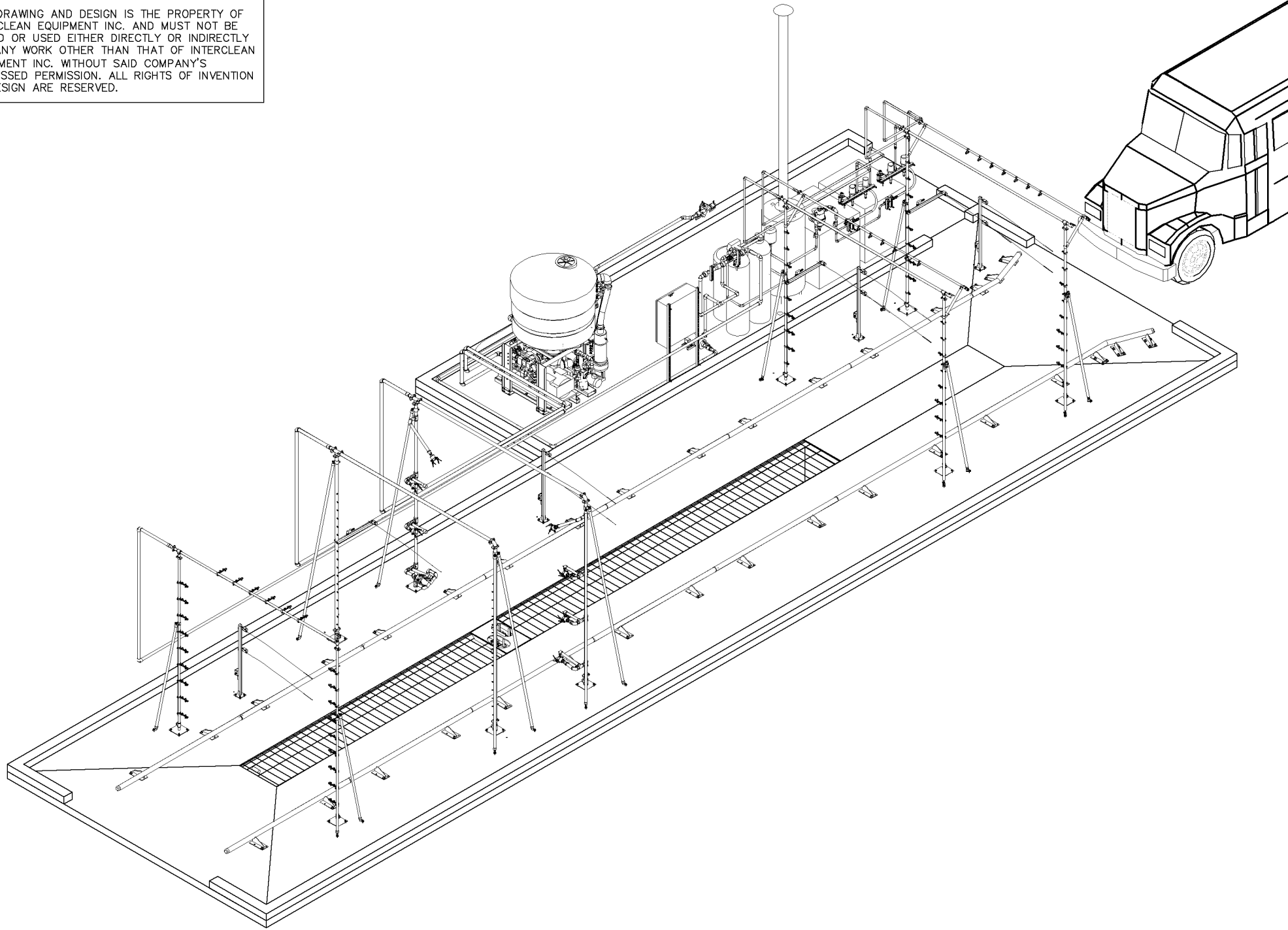

PROJECT:\Standard\ReclaimSystem2_Standard2_BusWash2_2Chemical\BusReclaim2.dwg, 01_3D, 7/31/2008 8:29:29 AM, Susan, HPD,1065CM.pcs

InterClean Equipment, Inc.

DESIGN: DRAWN:
 SUSAN SUSAN
 CHECK: APPR:
 PK #####
 SCALE:
 NO SCALE

BUS WASH, TWO STEP
 RECLAIM WATER SYSTEM
 3-D VIEW

DATE:
 MM/DD/YY
 PART NO:
 #LY05-RB2-01
 WEIGHT:

07/30/08	THE STANDARD LAYOUT UPDATED
R. DATE	DESCRIPTION

SL	
BY	APPR

NOTE:
THIS DRAWING AND DESIGN IS THE PROPERTY OF INTERCLEAN EQUIPMENT INC. AND MUST NOT BE COPIED OR USED EITHER DIRECTLY OR INDIRECTLY FOR ANY WORK OTHER THAN THAT OF INTERCLEAN EQUIPMENT INC. WITHOUT SAID COMPANY'S EXPRESSED PERMISSION. ALL RIGHTS OF INVENTION OR DESIGN ARE RESERVED.

NOTE:
DURING INSTALLATION, MAKE SURE THE TIRE GUIDE AND ARCHES DO NOT INTERFERE WITH ENTRANCE OR EXIT OVERHEAD DOORS

BACK FLOW PREVENTER LOCATION SHOWN FOR REFERENCE ONLY (PROVIDED BY GENERAL CONTRACTOR)

(2) 250 GAL. CHEMICAL TOTE SHOWN FOR REFERENCE ONLY, PROVIDED BY CHEMICAL SUPPLIER

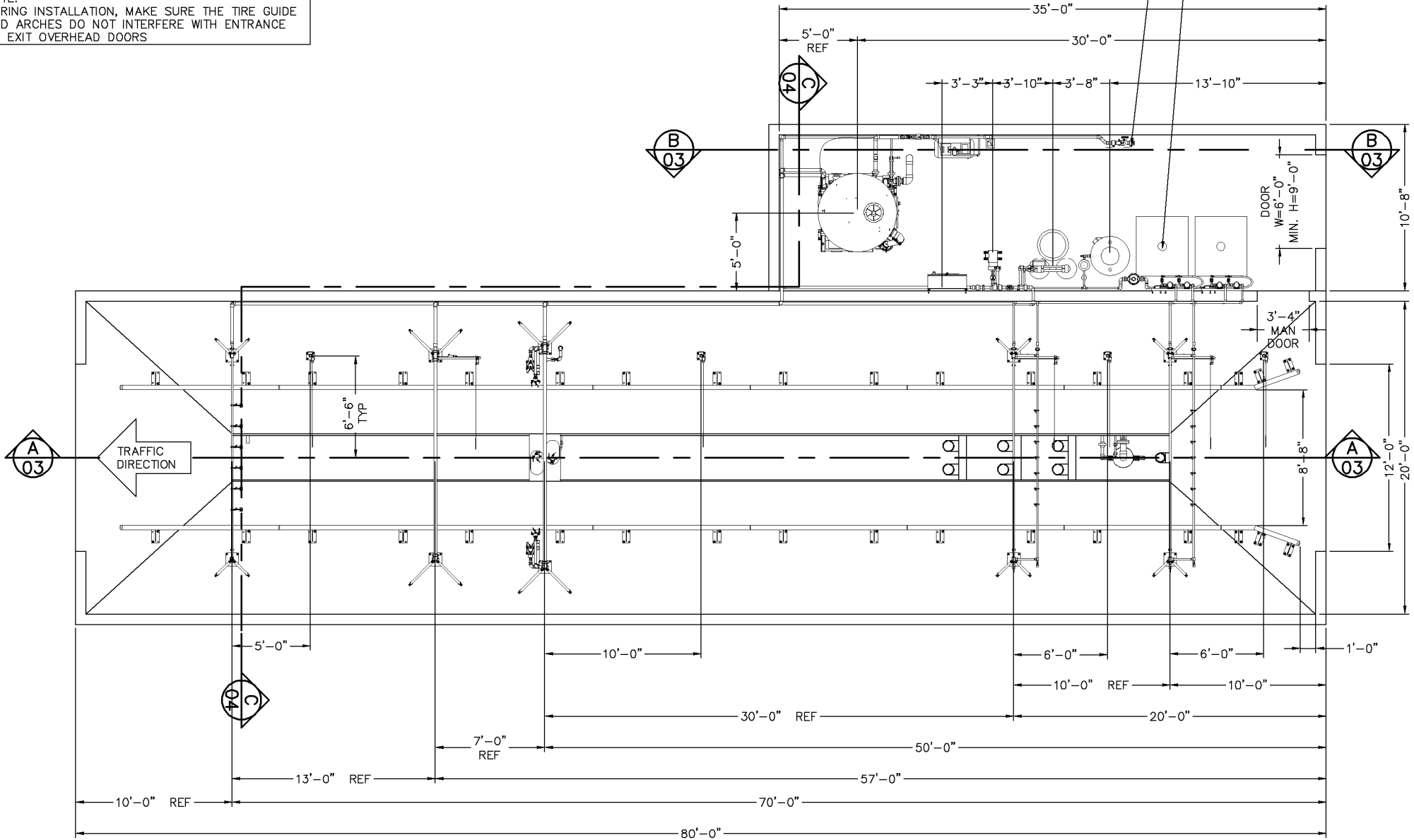

InterClean Equipment, Inc.

DESIGN: SUSAN
DRAWN: SUSAN
CHECK: APPR:
PK: #####
SCALE: 1/4"=1'

BUS WASH, TWO STEP
RECLAIM WATER SYSTEM
PLAN VIEW

DATE: MM/DD/YY
PART NO:
#LY05-RB2-02
WEIGHT:

A 07/30/08 THE STANDARD LAYOUT UPDATED
R. DATE DESCRIPTION

SL
BY APPR

PROJECT: Standard2_ReclaimSystem2_Standard2_BusWash2_ChemicalBusReclaim2.dwg, 02_Plan, 7/31/2008 8:30:51 AM, Susan, IHPD1105COM.pcb3